

ZION LUTHERAN CHURCH CEMETERY

SANDOVAL COMMUNITY

WILLIAMSON COUNTY, TEXAS

**ZION LUTHERAN CHURCH CEMETERY
HISTORICAL MARKER DEDICATION**

Sunday May 7, 2006, 10:30 a.m.

WELCOME

Claire Maxwell, WHC

INVOCATION

Pastor Walter J. Miller

**FLAG RAISING/
PLEDGE OF ALLEGIANCE**

VFW Post 4009

HISTORY

Janet Munroe

UNVEILING OF THE MARKER

**Terry Miksch
Karen Hines**

WORDS OF THANKS

Marcella Schoener

REFRESHMENTS AND FELLOWSHIP

PLEDGE OF ALLEGIANCE

**I pledge allegiance to the flag
of the United States of America
and to the Republic for which it stands,
one Nation, under God, indivisible
with liberty and justice for all.**

ZION LUTHERAN CHURCH CEMETERY

The Sandoval Community was settled by Carl Streich in 1882. The settlement consisted of German, some Austrian and Swiss, and a few French immigrants.

On March 25, 1893, twenty-six families formally organized Zion Lutheran Church. The first pastor was J. Rode, and the services were conducted in the German language.

On September 29, 1894, Paul and Emma Herbst donated one acre of land across the road from the original church to be used for a church and a cemetery.

This cemetery, located five miles north of Thrall, Texas, on County Road 425, is unfenced and contains eighty-seven known gravesites and ten unknown gravesites that are marked with white, iron crosses. The oldest documented gravesite is for Bertha Lehmann, a baby girl who died

in 1893. The last person buried in the cemetery is Kurt Bohlen who died on July 29, 1998.

There are three veterans buried in our cemetery. Two of them served during World War I: Henry Fuessel died in France, and one is unknown. Erich A. Schlickeisen served in World War II.

The cemetery still serves as a burial site for the members of Zion Lutheran Church and their families.

Gemeinde of Linden

1894

- | | | | |
|----|------------------------|--|--|
| 1 | F. Dylinski | | |
| 2 | F. Jackson | | |
| 3 | H. Johnson | | |
| 4 | S. Sippel | | |
| 5 | J. Taylor | | |
| 6 | J. Child | | |
| 7 | J. W. Chomillas | | |
| 8 | H. Malton | | |
| 9 | J. Sippel | | |
| 10 | H. Wanda | | |
| 11 | M. Chandra | | |
| 12 | J. Waring | | |
| 13 | W. W. Child | | |
| 14 | J. Wanda | | |
| 15 | J. W. Malton | | |
| 16 | W. W. Wanda | | |
| 17 | J. Dylinski | | |
| 18 | J. W. Wanda | | |
| 18 | L. Sippel | | |
| 19 | S. Dylinski | | |
| 20 | J. Wanda | | |
| 21 | A. Wanda | | |
| 22 | J. Sippel | | |
| 23 | J. Preusse | | |
| 24 | J. Peters | | |
| | L. W. Child | | |

Church members in 1894

**ZION LUTHERAN CHURCH CEMETERY
SANDOVAL COMMUNITY**

Zion Lutheran Church Cemetery is located in the Sandoval Community
At 611 CR425 off FM1063 five miles north of Thrall, Texas

Row 1

Franz Ebel
06-22-1859
10-05-1901

Helen Lehmann
08-1922
08-1922

Anton Boeckmann
1853-1936
Bertha Boeckmann
1868-1945

Row 2

Oscar Schoener
06-09-1875
09-10-1903

Emma Lehmann
09-29-1895
06-10-1910

Annie Schultz
03-16-1899
03-22-1899

Bertha Lehmann
1893-1893

Alvin W. Wendland
09-01-1899
09-27-1899

Edward Zenkner
12-1897
1939

Unknown
WWI

Ferdinand Schlickeisen
1840-1919
Marie Schlickeisen
1845-1882

Unknown

Conrad Ochsner
10-10-1847
02-10-1929

Anna Galler
01-17-1853
08-16-1908

Herman Lehmann
03-09-1858
07-12-1898

Gottlieb Galler
03-06-1818
01-31-1911

Ida Lehmann
06-02-1897
11-14-1897

Herman Galler
11-23-1857
07-28-1911

Row 2 (cont'd)

Gustav W. Galler
10-15-1917
09-15-1918

B. Vousch
04-26-1903
11-16-1903

Row 3

Ludwig Fuessel
02-07-1863
01-22-1939
Pauline Fuessel
01-17-1866
09-09-1924

Gus Limmer
01-1894
11-1958

Connie Limmer
06-28-1859
01-22-1943

Carolina M. Schultz
07-29-1890
02-22-1905

Frederick W. Limmer
08-01-1854
02-10-1928

Johanna M. Galler
08-04-1859
02-09-1901

Herbert Zeplin
05-09-1899
06-07-1899

Row 4

Frank H. Nolte
08-25-1856
09-12-1919
Mary F. Nolte
07-29-1856
04-13-1944

Row 5

Erhard J. Galler
07-13-1911
06-25-1913.

Lisetta Nolte
12-29-1883
07-31-1903

Unknown

Albert C. H. Limmer
08-12-1897
02-12-1920

Maria A. Schoenfeld
04-16-1896
02-19-1901

Herman Limmer
06-17-1889
01-25-1916

Adelle Obermueller
07-16-1887
09-19-1902

John L. Hofman
02-28-1826
05-07-1913

Otto Becker
04-13-1912
10-23-1913

Row 6

Unknown

Wilhemina Newman

10-15-1854

Unknown

05-09-1912

Paul E. Schlickeisen

Hilde F. M. Newman

11-22-1901

03-14-1911

08-03-1912

05-26-1912

Erich A. Schlickeisen

John P. Schlickeisen

05-11-1909

04-23-1872

09-05-1971

04-13-1941

Freiderike Schlickeisen

Katherine I. Schlickeisen

04-04-1876

10-18-1951

08-06-1961

07-30-1957

Ludmila Schlickeisen

Albert R. Schlickeisen

03-01-1906

03-01-1906

07-30-1957

03-23-1972

Jeanette F. Schlickeisen

Herman W. Gross

04-07-1953

03-11-1834

07-30-1957

12-02-1899

Inez A. M. Gross

Amalie A. Gross

12-25-1901

01-23-1832

07-19-1903

11-12-1900

Waldmer H. Gross

Louise Gross

04-19-1899

1876

02-27-1919

04-03-1913

Regina E. Gross

08-31-1901

Maria B. E. Streich

08-23-1911

08-18-1908

Viola G. E. Becker

04-17-1918

02-02-1911

Annie Schier

06-01-1911

08-13-1859

Row 7

01-11-1940

Unknown

Fred W. Schier

08-11-1856

08-27-1928

Row 7 (cont'd)

Werner W. Hackemesser
03-01-1929
12-25-1930

Row 8

Herman P. Schoener
01-20-1906
02-11-1936

Herman F. C. Schoener
05-10-1867
03-10-1946

Anna U. D. Schoener
02-09-1868
07-07-1932

David C. Obermiller
06-20-1919
10-08-1932

Fred M. Obermiller
02-08-1914
06-26-1915

Imke Goetz
09-12-1908
11-06-1932

Katherine A. Goetz
09-19-1912
09-20-1914

Unknown

Otto A. Klotz
01-02-1913
01-09-1913

Row 9

Unknown

Unknown

Emma Walther
10-24-1866
01-05-1929
Albert Walther
10-31-1863
05-13-1922

Verner R. Grabs
10-05-1916
06-05-1917

John Gollrad, Jr.
10-25-1915
12-03-1915
Rose Schoener
12-16-1917
Margaretha B. Schoener
12-13-1922
12-20-1922
Baby Pircher
02-06-1928
02-06-1928

Elsa E. W. Gollrad
12-01-1888
11-07-1915

Albert Kaatz
11-24-1910

Reinhold W. Hiebel
07-16-1852
12-12-1926

Row 10

Empty

Row 11

Elizabeth Fuessel
12-03-1852
07-15-1939

Otto L. Fuessel
04-24-1853
04-25-1934

Henry Fuessel
11-07-1890
01-05-1919

Fritz Benad
1889-1929
Henrietta Benad
1857-1927
Gustav Benad
1855-1919

George S. Miller
06-02-1905
07-06-1973

Elizabeth Miller
1872-1936
Michael C. Miller
1870-1918

Emma B. Tipps
03-06-1899
05-03-1976

Glenda J. Wernecke
07-29-1947
07-29-1947

Fredrick P. Leschber
06-12-1918
07-27-1918

Unknown

Row 12

Empty

Row 13

Baby Girl Kerlin
10-24-1934
10-24-1934

John Kroeger
08-11-1875
11-19-1930

Twin Daughters (Pasemann)
12-29-1927

Sophie Aerni
1871-1938

Hulda Galler
06-14-1883
02-10-1925

Ferdinand Jechow
04-08-1844
07-27-1924

Louise Jechow
01-11-1844
04-22-1924

Diedrich Renne

Row 14

Unknown

Kurt E. Bohlen
08-25-1928
07-29-1998

Row 14 (cont'd)

George D. Bohlen

08-28-1893

05-10-1983

Louise S. Bohlen

12-28-1894

01-14-1982

Gustav Staudte

04-19-1863

08-29-1941

Friedricke P. Staudte

03-21-1867

12-08-1940

John G. Oeltgen

10-25-1872

02-16-1932

Anna B. Oeltgen

09-04-1858

08-08-1942

Glady M. Hurta

05-23-1936

06-09-1936



TEXAS HISTORICAL COMMISSION
CERTIFIES THAT

ZION LUTHERAN CHURCH CEMETERY
WILLIAMSON COUNTY

IS RECORDED AS A
HISTORIC TEXAS CEMETERY

IN 2003

EXECUTIVE DIRECTOR, TEXAS HISTORICAL COMMISSION

DIRECTOR, HISTORY PROGRAMS DIVISION

EXHIBIT "A"

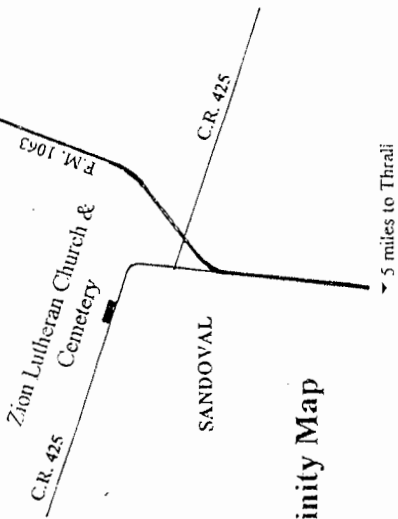

Vicinity Map

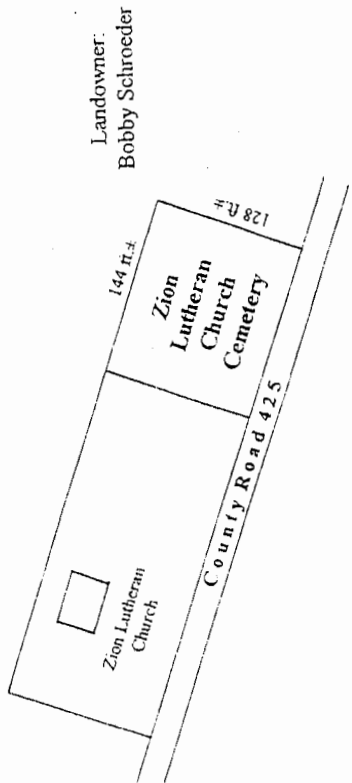

Morning Star
 REALTY & INVESTMENT
 159 Dickerson Ln., Elgin, TX 78621
 512-281-2981 (c) 2008
 cdre@msr.com

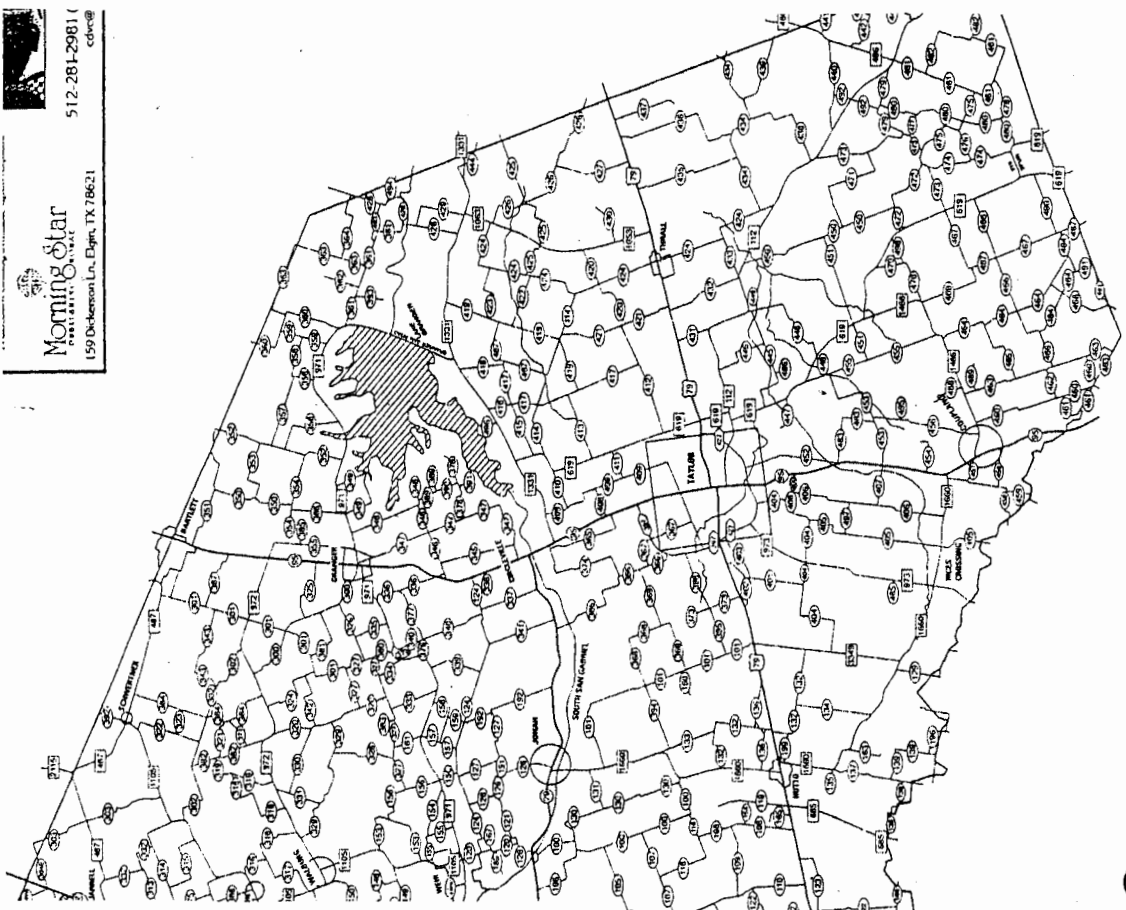

WILLIAMSON COUNTY, TEXAS

THANKS TO:

Keith Crabb

For helping make the base to the historical marker.

Nora Haag

For help copying the information from the tombstones.

Lisa Heselmeyer

Cleaning crosses and tombstones.

Steven Hezelmeyer

For helping make the base to the historical marker and cleaning tombstones.

Karen Hines

Donating the cake, donating the flowers for the church altar, and helping unveil the historical marker.

Frank Hines

For helping make the base to the historical marker.

**Alfred Lehmann
Arthur Lehmann**

For marking the unknown gravesites; getting and installing the white crosses and brass name plates; designing, framing, and pouring the concrete for the historical marker; and organizing the cleaning of the cemetery.

Stephanie Link

Preparing crosses for painting and cleaning tombstones.

Martha Society

For providing the chairs for guests at the cemetery

	dedication, providing the tables and chairs and the refreshments afterward.
Claire Maxwell	For opening the dedication ceremony and explaining the importance of preserving our cemeteries.
Terry Miksch	For helping to unveil the historical marker.
Pastor Walter J. Miller	For helping with the preparation of the dedication and giving the invocation for the Sunday school and historical marker dedications.
Janet Monroe	Painting crosses, cleaning tombstones, and reading the history of the cemetery.
Herman Schoener	For measuring the cemetery and translating most of the tombstones written in German.
Marcella Schoener	Mapping the unknown gravesites, copying information from tombstones, typing the information on state required forms, creating a new chart of the cemetery, compiling all the information to send to the state to get the state certificate, completing the form to the Williamson County Historical Commission needed for our historical marker, and

**providing the cover for the
historical marker.**

Dick & Bernice Sciortino

**For identifying unmarked
gravesites; taking black and
white pictures of the cemetery,
tombstones, and white crosses;
filing the required forms to
the Williamson County
Historical Commission to obtain
historical marker for the
cemetery; and being the Master
of Ceremonies for the cemetery
historical marker dedication.**

Wilbert Unnasch

For helping clean tombstones.

VFW Post #4009

**For raising the American flag
and leading the Pledge of
Allegiance**